

90	1.15	2.84 ^s	1.63 ^s	1.22	1.80	1.20
48	2.38 ^s	11 ^s	4.11 ^s	2.38 ^s	1.30	48
48	1.94 ^s	3.46	11 ^s	2.60	11 ^s	3.50
10.75						

Erdgeschoß 75.49qm n.2 BV
Nutzfl.~77.61qm

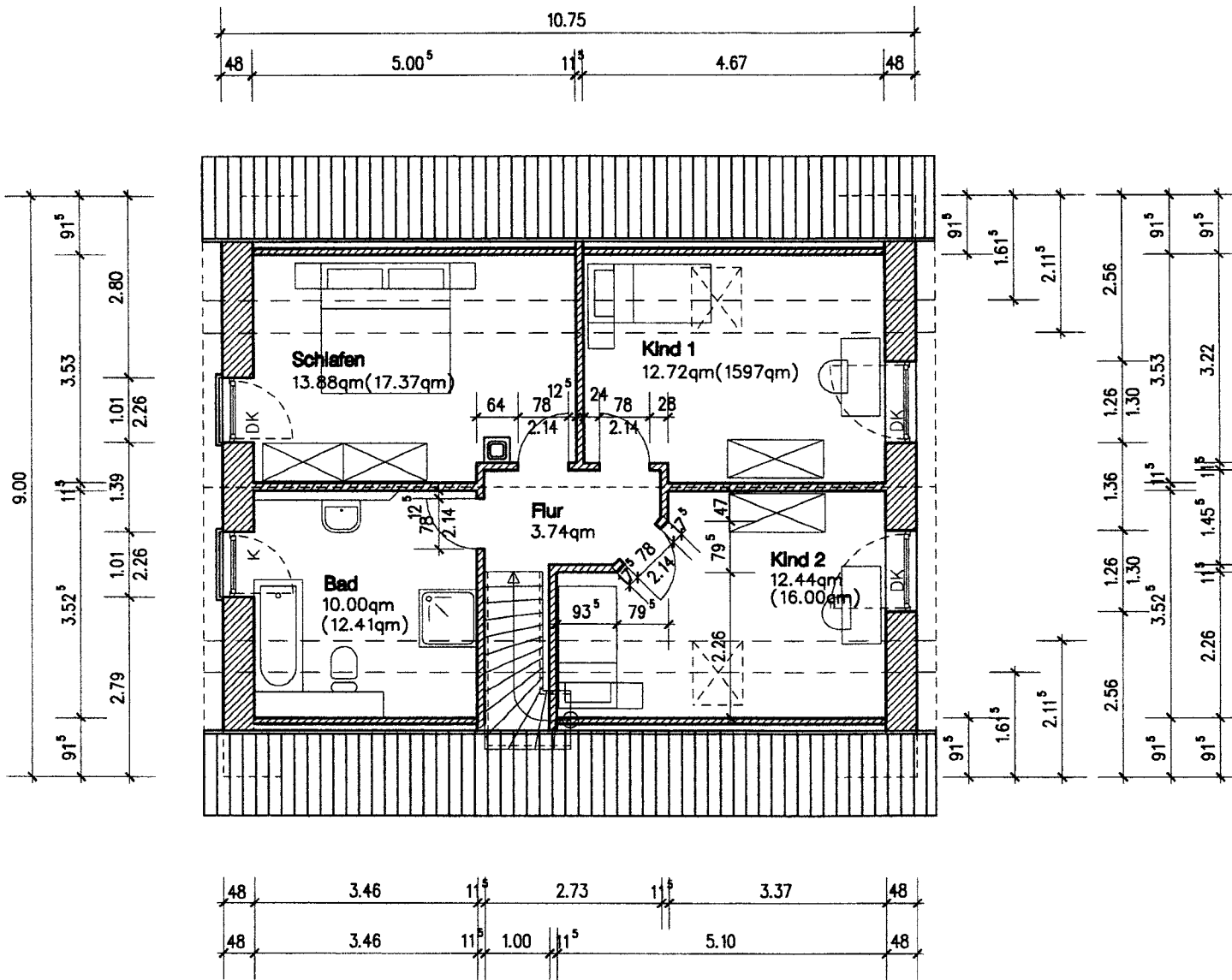

Dachgeschoß 52.78qm n. 2 BV
Nutzfl. ~65.49qm

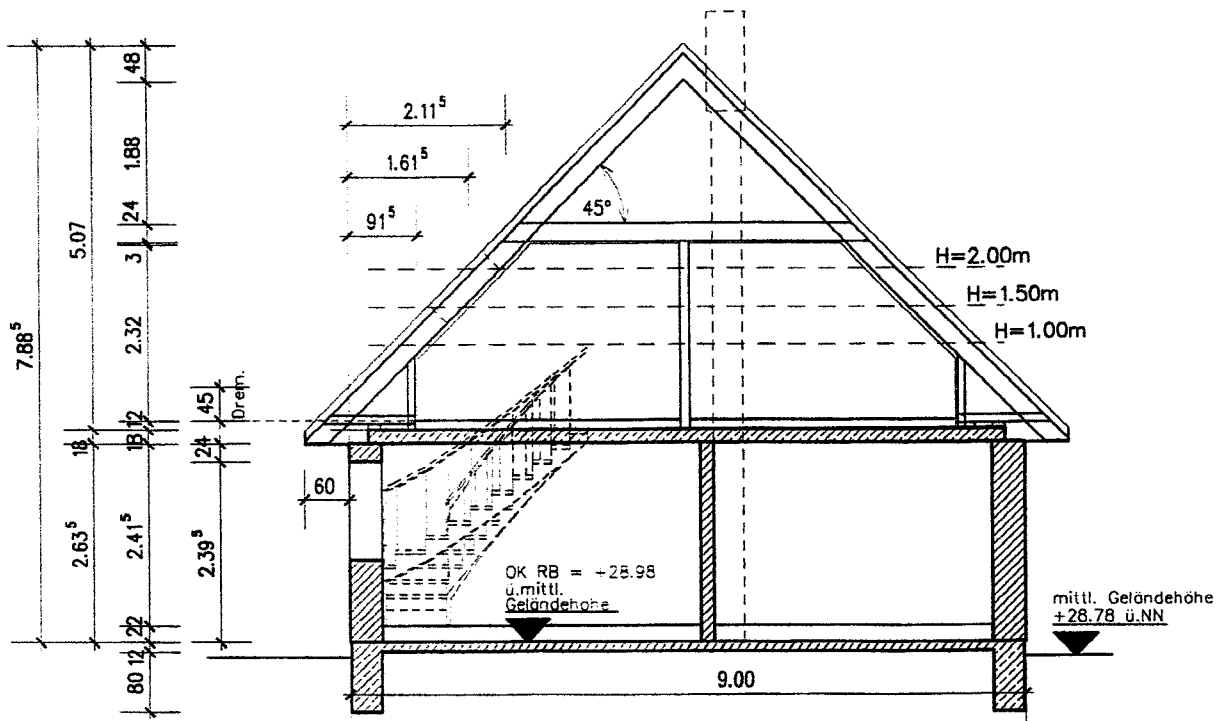

Schnitt